

# Trim Tab Installation Instructions

## Part # HP-1000T

### PARTS INCLUDED IN THIS KIT

- (2) TRIM TABS
- (2) HYDRAULIC PUMPS.
- (4) 30" SS HYDRAULIC LINES
- (1) TRICK DASH SWITCH
- (1) COMPLETE BOLT KIT FOR BOTH TRIM TABS

### NOTE:

USE SILICONE SEALER, ON ALL TRIM LINES THROUGH TRANSOM FITTINGS AND BOLTS..

AFTER ALL HYDRAULIC LINES ARE INSTALLED AND TIGHTENED, FILL PUMP TO THE MAX WITH 30 WEIGHT MOTOR OIL FOR HYDRAULIC FLUID.

CYCLE BOTH TABS " UP AND DOWN" SEVERAL TIMES WHILE CHECKING FOR LEAKS (PUMP IS SELF- BLEEDING). REFILL HYDRAULIC TANK TO MAX.

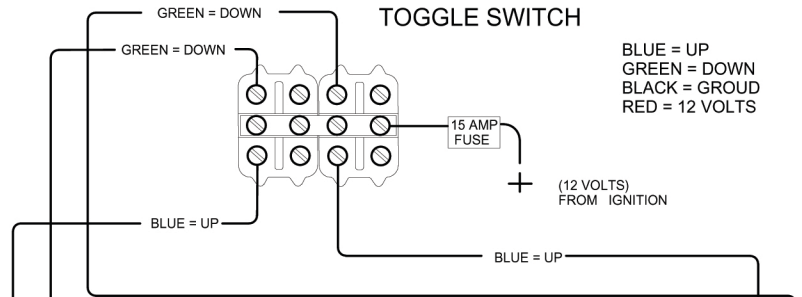

### STEP 1

### STEP 2

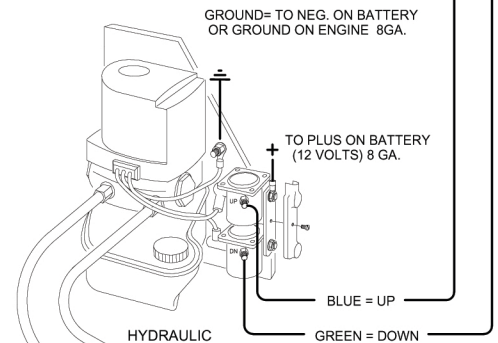
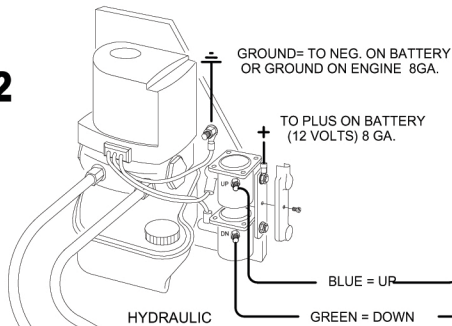

MOUNT TRIM TABS 1/4" INCH UP FROM BOTTOM OF BOAT

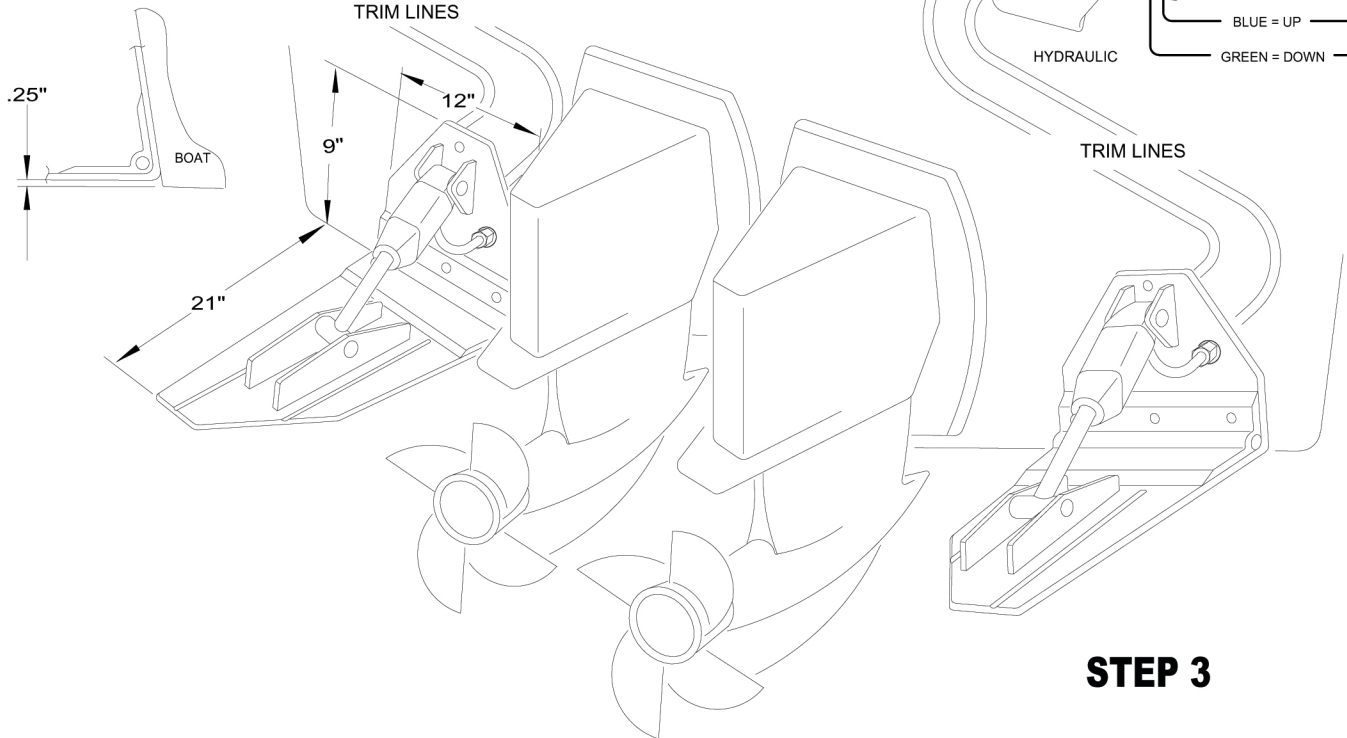

### STEP 3